

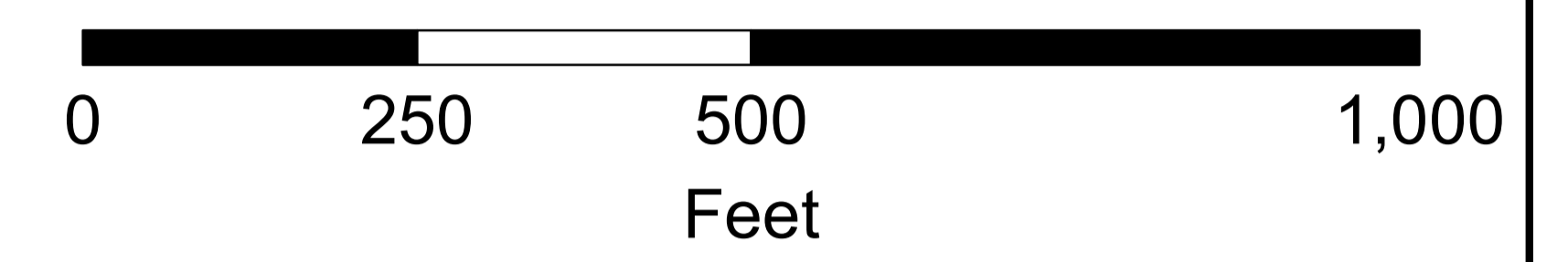

DEPARTMENT OF PLANNING & BUILDING

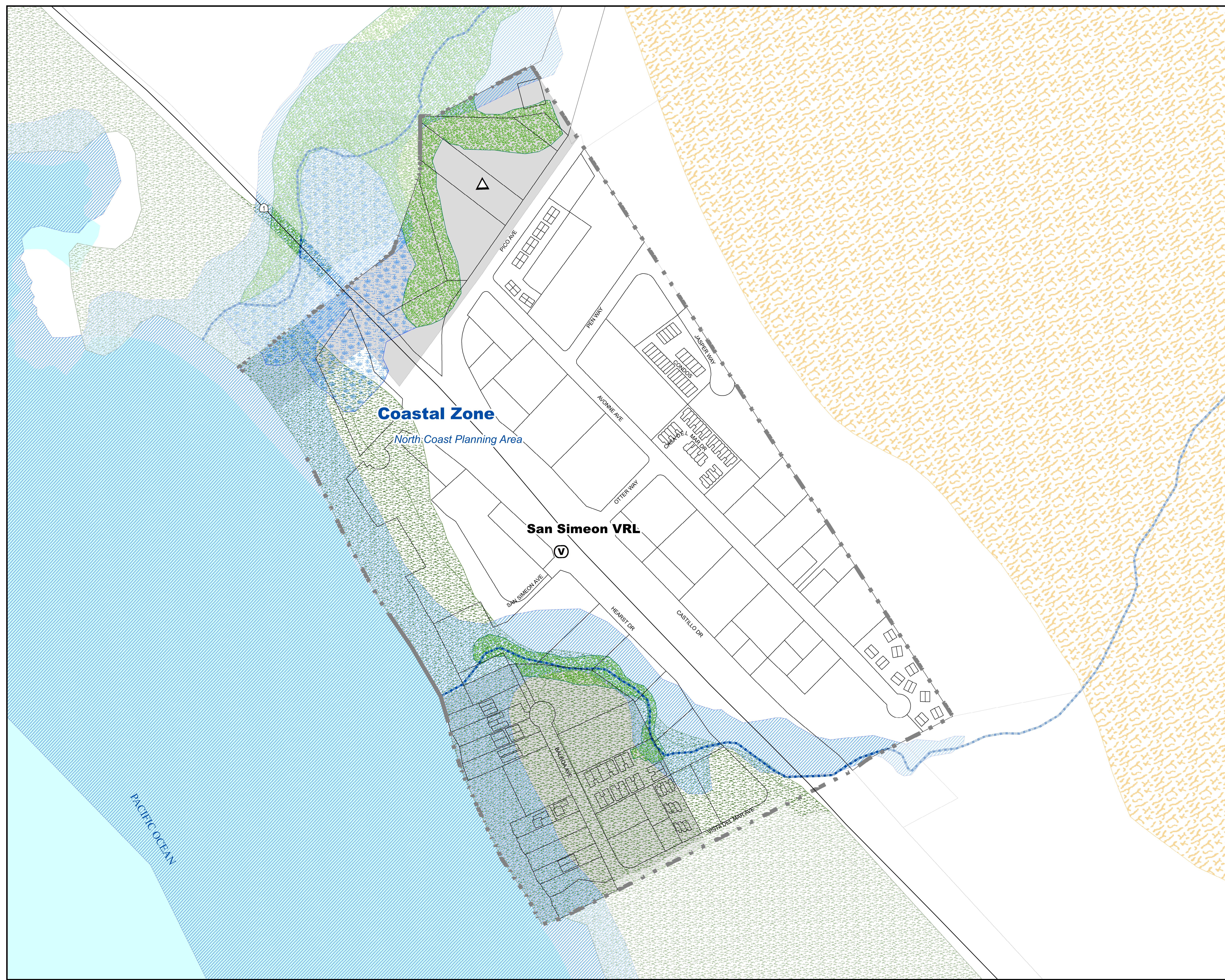

SAN SIMEON VILLAGE RESERVE LINE COMBINING DESIGNATIONS MAP



- LEGEND**
- Coastal Zone Boundary
  - Lake or Pond
  - Planning Area Boundary
  - Planning Sub Area Boundary
  - Urban Service Line
  - San Simeon Village Reserve Line
  - Combining Designations**
    - H - Historic
    - V - Visitor Serving Area
    - ASA - Archaeological Sensitive Area
    - AR - Airport Review Area
    - EX - Extractive Area
    - EX 1 - Energy Extractive Area
    - Flood Hazard
    - GSA - Geologic Study Area
    - GSA - Alquist-Priolo
    - SRA - Sensitive Resource Area
  - Environmentally Sensitive Habitat**
    - Coastal Stream
    - Marine Habitat
    - Riparian Vegetation
    - Terrestrial Habitat
    - Wetland
  - Proposed Public Facilities**
    - Fwy Interchange
    - Proposed Elementary School
    - Proposed Government Facility
    - Proposed High School
    - Proposed Library
    - Proposed Park
    - Proposed Police Station
    - Proposed Sewage Treatment Facility
    - Proposed Solid Waste Facility
    - Proposed Water Treatment Facility
    - Reservoir

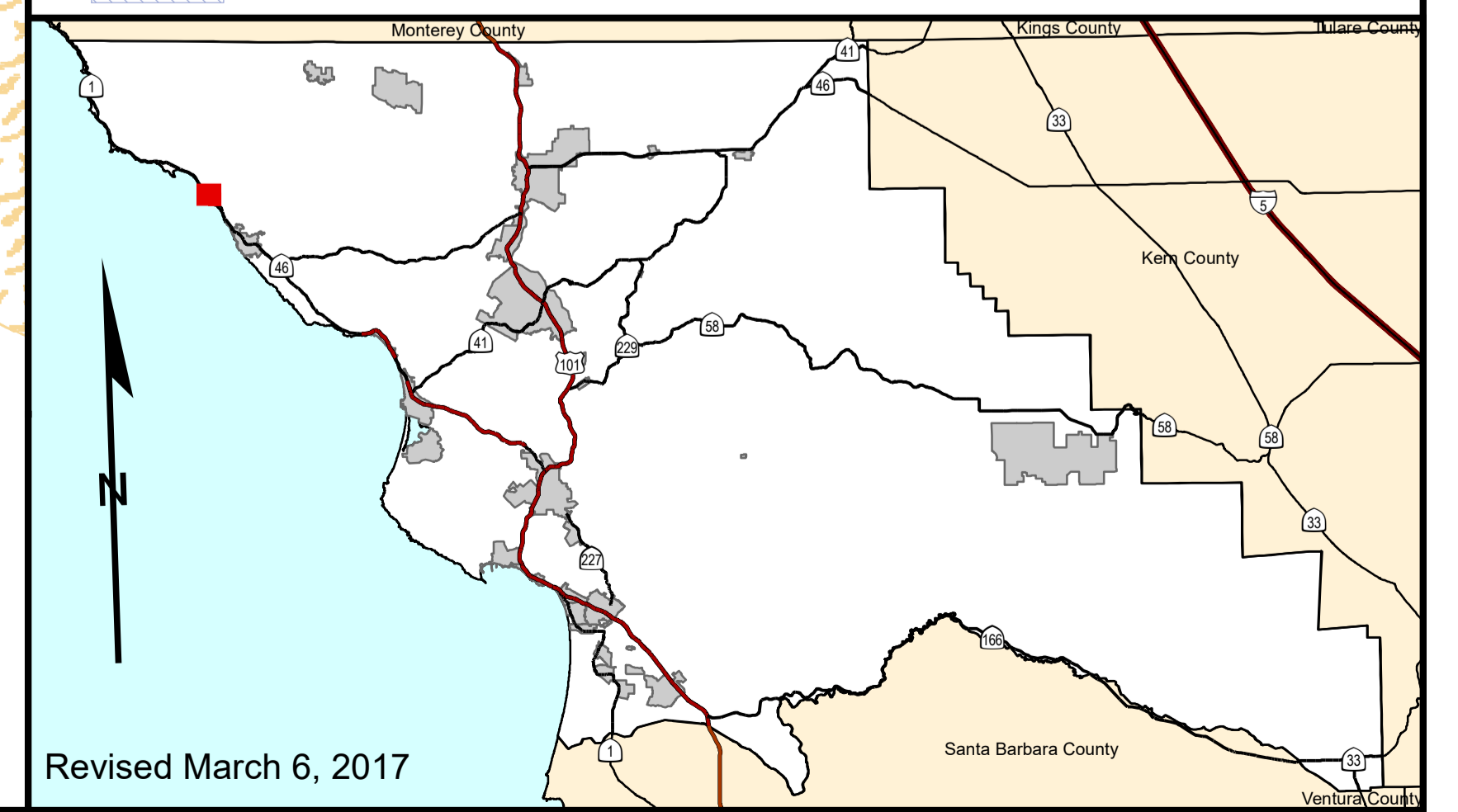

Revised March 6, 2017

Sources: County of San Luis Obispo, Department of Planning and Building, ParcelQuest, USGS National Hydrography Dataset, California Department of Finance, FEMA