



Cash for Grass Program Application

(Nipomo Mesa Water Conservation Area and Paso Robles Groundwater Basin)

Step 1:

The Cash for Grass Rebate Program is administered on a first-come, first-serve basis subject to availability of program funding. Property owners in the Nipomo Mesa Water Conservation Area and the Paso Robles Groundwater Basin who meet the criteria outlined in the attached Terms and Conditions may apply for a rebate. **Application must be received and approved prior to turf removal.**

Applicant Details: (please print clearly)	
Name:	Jane Jones
Phone:	(805) 123-4567
Alt Phone:	(805) 899-9999
E-mail:	janejones@yahoo.com
Address of property where turf will be removed:	
Address:	805 Osos Street, Nipomo, CA 93444

Check this box if your mailing address is the same as the address of the property where turf will be removed.

Mailing Address:
Address:
City:
State:
Zip Code:

Project Information:
Square footage of turf to be removed: <u>1,000</u> (County staff will verify measurements during the pre-conversion inspection)
Please attach the following required documents :
<input checked="" type="checkbox"/> Existing (pre-conversion) Landscape Plan Note: This plan can be hand drawn by the applicant as long as it accurately reflects the project area.
<input checked="" type="checkbox"/> Proposed Landscape Plan showing replacement plants and materials
<input checked="" type="checkbox"/> List of plant types and number of plants that will replace turf (program requires 10% of proposed landscaping to include a minimum of 20% living material).
<input checked="" type="checkbox"/> Landscape plans shall conform to the requirements of any landscape ordinance, if applicable, for the project area.

I am the property owner of record of his or her legally authorized representative. I have read, understand, and agree to the attached Terms and Conditions, which are incorporated herein by reference.

X Jane Jones 2/1/17
 Signature of property owner or Legally Authorized Representative (Attach authorization documentation) Date



Agreement

I (print name), Jane Jones, am the legal owner of the property described above or have obtained written consent from the property owner to participate in the "Cash for Grass" program. I am voluntarily participating in the County of San Luis Obispo's "Cash for Grass" program and will perform the installation of irrigation equipment and landscape materials described above. I independently selected materials, supplies and labor the purpose of performing the installation. I agree that all work performed complies with applicable state and local laws, ordinances and regulations. As long as I maintain ownership of the property, I agree to retain the new irrigation hardware and/or landscape, or replace them in the future with hardware or landscape materials that conform to equal or better standards of water conservation. I understand that the replacement low water use landscaping must remain in place in perpetuity, and that if I sell the property, I must inform the future owners of their obligation to participate in this agreement.

I will allow the County to conduct site visits to my property within five years of the date of this Agreement for purposed of collecting data and photographs of the project site. The County will contact me in advance to arrange times for these visits.

I agree that by virtue of program inspections, the County of San Luis Obispo makes no determination with respect to whether materials and equipment are free of defects, the quality of the workmanship, the suitability of the premises or the materials or equipment for the installation. I also understand that the installation of irrigation equipment and landscape materials described above may not result in lower water costs. I agree to defend, indemnify and hold harmless the County of San Luis Obispo, its directors, officers, agents and employees against any and all loss, liability, expense, claims, suits and damages, including attorney's fees, arising out of or resulting from the installation of irrigation equipment and landscape materials or from participation in this program.

I am responsible for complying with all applicable laws, regulations, ordinances, or other legal requirements, and nothing in this agreement shall excuse or modify any such requirements.

By signing below, I agree that any water credits attributable to the water savings from the installation of a low water use landscape initiated through the Program, if any, shall be held by the County. I certify that the information on this Application is true and correct and that I have read, understand and agree to the standards, process, terms, and conditions of this rebate program.

Signature: Jane Jones
Date: 2/1/17



Groundcovers

#	Botanical Name	Common Name	Water Use
	Acacia redolens	prostrate acacia	Very Low
	Adenostoma fasciculatum	chamise	Very Low
2	Artemisia spp. (shrubby)	sagebrush	Very Low
	Atriplex CA native species	saltbush	Very Low
	Atriplex semibaccata	Australian saltbush	Very Low
	Iva hayesiana	poverty weed	Very Low
	Teucrium cossonii	Majorcan germander	Very Low

#	Botanical Name	Common Name	Water Use
	Achillea millefolium (CA native cultivars)	yarrow	Low
	Achillea tomentosa	woolly yarrow	Low
	Aptenia "Red Apple"	ice plant (Red Apple)	Low
	Aptenia cordifolia	ice plant (Aptenia)	Low
	Arctostaphylos "Pacific Mist"	Pacific Mist manzanita	Low
	Arctostaphylos edmundsii "Bert Johnson"	Bert Johnson manzanita	Low
	Arctostaphylos edmundsii "Big Sur"	Big Sur manzanita	Low
	Arctostaphylos edmundsii "Rosy Dawn"	Rosy Dawn manzanita	Low
	Arctostaphylos hookeri "Buxifolia"	Buxifolia manzanita	Low
	Arctostaphylos hookeri "Ken Taylor"	Ken Taylor manzanita	Low
	Arctostaphylos hookeri "Monterey Carpet"	Monterey carpet manzanita	Low
	Arctostaphylos hookeri "Wayside"	Wayside manzanita	Low
	Arctostaphylos uva-ursi "Point Reyes"	Pt. Reyes manzanita	Low
	Arctostaphylos uva-ursi "Radiant"	Radiant manzanita	Low
	Arctostaphylos uva-ursi "San Bruno Mountain"	San Bruno Mtn manzanita	Low
	Arctostaphylos uva-ursi "Tom"s Point"	Tom"s Point manzanita	Low
	Arctostaphylos uva-ursi "Wood"s Compact"	Wood"s compact manzanita	Low
	Artemisia californica "Canyon Gray"	Canyon Gray sagebrush	Low
	Artemisia californica "Montara"	Montara sagebrush	Low
	Artemisia spp. (herbaceous)	angel"s hair	Low
	Baccharis pilularis cvs.	dwarf coyote brush	Low
	Berberis aquifolium var. repens (shade)	creeping mahonia	Low
	Bougainvillea spp.	bougainvillea	Low
	Carissa macrocarpa (prost.cvs.)	Natal plum	Low
	Carpobrotus spp.	ice plant (Carpobrotus)	Low
	Ceanothus "Centennial"	Centennial ceanothus	Low
	Ceanothus gloriosus "Anchor Bay"	Anchor Bay ceanothus	Low
	Ceanothus gloriosus "Heart"s Desire"	Heart"s Desire ceanothus	Low
	Ceanothus gloriosus "Emily Brown"	Emily Brown ceanothus	Low
	Ceanothus hearstiorum	San Simeon ceanothus	Low
	Ceanothus maritimus "Frosty Dawn"	Frosty Dawn ceanothus	Low
	Ceanothus maritimus "Popcorn"	Popcorn CA lilac	Low
	Ceanothus maritimus "Pt. Sierra"	Pt Sierra ceanothus	Low
	Ceanothus maritimus "Valley Violet"	Valley Violet ceanothus	Low
	Ceanothus thyrsiflorus var. griseus "Carmel Creeper"	Carmel Creeper ceanothus	Low
	Ceanothus thyrsiflorus var. griseus "Diamond Heights"	Diamond Heights ceanothus	Low
	Cephalophyllum spp.	ice plant (Cephalophyllum)	Low
	Ceratostigma plumbaginoides	dwarf plumbago	Low
	Chamaemelum nobile (Anthemis nobilis)	chamomile	Low
	Cistus spp. and cvs.	rockrose	Low
	Convolvulus mauritanicus	ground morning glory	Low
	Coprosma petriei "Verde Vista"	Verde Vista coprosma	Low
	Coprosma x kirkii	creeping coprosma	Low
	Cotoneaster dammeri "Coral Beauty"	bearberry cotoneaster	Low
	Cotoneaster dammeri "Lowfast"	bearberry cotoneaster	Low
	Cotoneaster horizontalis	rock cotoneaster	Low
	Dampiera diversifolia	dampiera	Low
	Darwinia citriodora "Seaspray"	lemon-scented myrtle	Low
	Delosperma spp.	ice plant (Delosperma)	Low
	Dichondra sericea	silver leaf pony"s foot	Low



COUNTY OF SAN LUIS OBISPO
 DEPARTMENT OF PLANNING & BUILDING
 976 Osos St., RM 300 + San Luis Obispo, CA + 93408

Dodonaea procumbens	hopseed bush (procumbens)	Low
Drosanthemum spp.	ice plant (Drosanthemum)	Low
Dymondia margaretae	dymondia	Low
Eriogonum fasciculatum "Theodore Payne"	Theodore Payne buckwheat	Low
Eriogonum fasciculatum "Warriner Lytle"	Warriner Lytle buckwheat	Low
Erodium chrysanthum	cranesbill (chrysanthum)	Low
Erodium reichardii (E. chaemedryoides)	alpine geranium	Low
Geranium incanum	carpet geranium	Low
Glechoma hederacea	ground ivy	Low
Grindelia stricta var. platyphylla	spreading gum plant	Low
Juniperus spp.	juniper	Low
Lampranthus spp.	ice plant (Lampranthus)	Low
Lantana camara & cvs.	lantana	Low
Lantana hybrids	hybrid lantana	Low
Lantana montevidensis (sellowiana)	trailing lantana	Low
Leptospermum rupestre (humifusum)	tea tree	Low
Lessingia filaginifolia "Silver Carpet" (Corethrogyne)	California beach aster	Low
Lotus corniculatus	birdsfoot trefoil	Low
Malephora spp.	ice plant (Maleophora)	Low
Mentha spp. (CA native and non-native spp.)	mint	Low
Muehlenbeckia complexa	maidenhair vine	Low
Myoporum parvifolium & cvs.	myoporum	Low
Myoporum X "Pacificum"	pacifica saltbush	Low
Oenothera speciosa (O. berlandieri)	Mexican evening primrose	Low
Oenothera stubbei	Baja evening primrose	Low
Oscularia deltoides	pink iceplant	Low
Osteospermum spp.	African daisy	Low
Parthenocissus tricuspidata	Boston ivy	Low
Pelargonium peltatum	ivy geranium	Low
Phyla nodiflora (Lippia nodiflora)	cape weed	Low
Pyracantha spp. & cvs.	firethorn	Low
Rhus aromatica (Rhus trilobata)	skunk bush	Low
Rosmarinus cvs.	trailing rosemary	Low
Salvia "Bee"s Bliss"	Bee"s Bliss sage	Low
Salvia "Dara"s Choice"	Sonoma sage	Low
Salvia chionophylla	snowflake sage	Low
Salvia sonomensis and cvs	Sonoma sage	Low
Salvia spathacea (shade) and cvs	hummingbird/pitcher sage	Low
Santolina spp.	lavender cotton	Low
Saponaria ocymoides	rock soapwort	Low
Sarcococca hookeriana humilis	sweet sarcococca	Low
Scaevola "Mauve Clusters"	fan flower	Low
Scaevola aemula	fairy fan	Low
Sedum spp. (some are Hylotelephium)	stone crop	Low
Senecio mandraliscae (Kleinia mandraliscae)	kleinia	Low
Senecio serpens	blue chalksticks	Low
Sollya heterophylla	Australian bluebell creeper	Low
Symphoricarpos mollis (shade in SD)	creeping snowberry	Low
Teucrium chamaedrys	germander	Low
Thymus praecox	mother-of-thyme	Low
Thymus spp. and cvs.	thyme	Low
Trifolium fragiferum O"Connor (revegetation use)	O"Connor"s legume	Low
Verbena peruviana	Peruvian verbena	Low
Verbena rigida	vervain	Low
Verbena stricta	hoary vervain	Low
Verbena tenera (pulchella)	rock verbena	Low
Verbena tenuisecta	moss verbena	Low
Zinnia grandiflora	prairie zinnia	Low



	Portulacaria afra & cvs.	elephant"s food	Very Low
	Quercus berberidifolia	California scrub oak	Very Low
	Quercus dumosa	Nuttall"s scrub oak	Very Low
	Quercus durata	leather oak	Very Low
	Rhagodia spinescens (R. deltophylla)	Australian saltbush	Very Low
	Ribes californicum	hillside gooseberry	Very Low
	Ribes malvaceum	chaparral currant	Very Low
	Ribes menziesii	canyon gooseberry	Very Low
	Romneya coulteri	Matilija poppy	Very Low
	Romneya trichocalyx	hairy Matilija poppy	Very Low
	Salvia apiana	white sage	Very Low
	Senecio flaccidus var. douglasii	Douglas groundsel	Very Low
	Senna multiglandulosa (Cassia tomentosa)	woolly senna	Very Low
	Simmondsia chinensis	jojoba	Very Low
	Spartium junceum	Spanish broom	Very Low
	Tamarix pentaphylla	tamarisk	Very Low
3	Trichostema lanatum	woolly blue curls	Very Low
	Trichostema parishii	mountain blue curls	Very Low
	Yucca aloifolia	Spanish bayonet	Very Low
	Yucca baccata	banana yucca	Very Low
	Yucca brevifolia	Joshua tree	Very Low
	Yucca elata	soaptree yucca	Very Low
	Yucca elephantipes	giant yucca	Very Low
	Yucca glauca	soapweed yucca	Very Low
	Yucca rigida	blue yucca	Very Low
	Yucca rostrata	beaked yucca	Very Low
	Yucca schidigera (Y. californica, Y. mohavensis)	Mojave yucca	Very Low

#	Botanical Name	Common Name	Water Use
	Abutilon palmeri	Indian mallow	Low
	Acacia boormanii	Snowy River wattle	Low
	Acacia cultriformis	knife acacia	Low
	Acacia glaucoptera	clay wattle	Low
	Acacia greggii	catclaw acacia	Low
	Acacia iteaphylla	willow wattle	Low
	Acacia linearifolia	golden wattle	Low
	Acacia longifolia	Sydney golden wattle	Low
	Acacia saligna	blue leaf wattle	Low
	Acacia subporosa	subporosa acacia	Low
	Adenanthos cuneatus "Coral Drift"	flame bush	Low
	Adenanthos detmoldii "Metallica"	yellow jugflower	Low
	Adenanthos drummondii	woolly bush	Low
	Adenanthos meisneri	woollybush	Low
	Adenanthos sericeus	coastal woolly bush	Low
	Agave attenuata (and thin-leaved relatives) (Ca native and non-	agave	Low
	Aloe spp. (CA native and non-native)	aloe	Low
	Aloysia triphylla	lemon verbena	Low
	Alyogyne huegelii	blue hibiscus	Low
	Amorpha californica (shade)	California false indigo bush	Low
	Arbutus unedo	strawberry tree	Low
	Arctostaphylos "Austin Griffiths"	Austin Griffiths manzanita	Low
	Arctostaphylos "John Dourley"	John Dourley manzanita	Low
	Arctostaphylos "Lester Rowntree"	Lester Rountree manzanita	Low
	Arctostaphylos "Sunset"	Sunset manzanita	Low
	Arctostaphylos bakeri "Louis Edmunds"	Louis Edmunds manzanita	Low
	Arctostaphylos densiflora cvs.	manzanita cvs. e.g. Howard McMinn, Sentinel	Low
	Arctostaphylos hookeri (shrub cvs.)	manzanita (shrub cvs.)	Low
	Arctostaphylos insularis	island manzanita	Low
	Arctostaphylos manzanita cvs.	manzanita cvs. e.g. Dr Hurd, St. Helena	Low
	Arctostaphylos morroensis	Morro manzanita	Low
	Arctostaphylos purissima "Vandenberg"	Vandenberg manzanita	Low
	Arctostaphylos refugioensis	Refugio manzanita	Low



Trees

#	Botanical Name	Common Name	Water Use
	Acacia dealbata	silver wattle	Very Low
	Acacia decurrens	green wattle	Very Low
	Acacia melanoxylon	blackwood acacia	Very Low
	Acacia stenophylla	eumong/shoestring acacia	Very Low
	Aesculus californica	California buckeye	Very Low
	Ailanthus altissima	tree of heaven	Very Low
	Arctostaphylos manzanita	common manzanita	Very Low
	Cercis occidentalis	western redbud	Very Low
	Chilopsis linearis	desert willow	Very Low
	Eucalyptus cinerea	ash leaved gum, silver dollar tree	Very Low
	Eucalyptus macrandra	long flowered marlock	Very Low
	Eucalyptus preissiana	bell mallee	Very Low
	Eucalyptus woodwardii	lemon flowered gum	Very Low
	Hesperocyparis arizonica (Cupressus arizonica)nomen.	Arizona cypress	Very Low
	Hesperocyparis macnabiana (Cupressus macnabiana)	MacNab cypress	Very Low
	Hesperocyparis stephensonii (Cupressus arizonica ssp.	Cuyamaca cypress	Very Low
	Melia azedarach	chinaberry	Very Low
	Olea europaea	olive	Very Low
	Parkinsonia aculeata	Mexican palo verde/ Jerusalem thorn	Very Low
	Parkinsonia florida (Cercidium florida)	blue palo verde	Very Low
	Parkinsonia microphylla (Cercidium microphyllum)	little leaf palo verde	Very Low
	Pinus attenuata	knobcone pine	Very Low
	Pinus longaeva	bristlecone pine	Very Low
	Pinus pinea	Italian stone pine	Very Low
	Pinus ponderosa	ponderosa pine	Very Low
	Pinus sabiniana	foothill pine	Very Low
	Quercus agrifolia	coast live oak	Very Low
	Quercus chrysolepis	canyon live oak	Very Low
	Quercus douglasii	blue oak	Very Low
	Quercus wislizeni	interior live oak	Very Low
	Quercus x morehus	oracle oak	Very Low
	Robinia pseudoacacia	black locust	Very Low
	Schinus molle	California pepper tree	Very Low
	Schinus polygamus	Peruvian pepper tree	Very Low
	Tamarix aphylla	salt cedar	Very Low
	Vachellia farnesiana (Acacia farnesiana)	sweet acacia	Very Low

#	Botanical Name	Common Name	Water Use
	Abies pinsapo	Spanish fir	Low
	Acacia baileyana	Bailey acacia	Low
	Acacia cognata (A.subporosa)	bower wattle	Low
	Acacia pendula	weeping acacia	Low
	Acacia pravissima	ovens wattle	Low
	Agonis flexuosa and cvs.	peppermint tree	Low
	Albizia distachya	plume albizia	Low
	Albizia julibrissin	silk tree	Low
	Allocasuarina torulosa	forest oak	Low
	Allocasuarina verticillata (Casuarina stricta)	coast beefwood	Low
	Angophora costata (Angophora cordifolia)	gum myrtle	Low
	Araucaria araucana	monkey puzzle tree	Low
	Araucaria bidwillii	bunya-bunya	Low
	Arbutus "Marina"	Marina arbutus	Low
	Arbutus andrachne	Greek strawberry tree	Low
	Arbutus menziesii (in shade in the CV)	madrone	Low
	Arbutus texana	Texas madrone	Low
	Arctostaphylos manzanita cvs.	manzanita cvs. e.g.Dr Hurd, St. Helena	Low
	Brachychiton acerifolius	flame tree	Low
	Brachychiton populneus	bottle tree	Low
	Brahea armata	blue hesper palm	Low

2/7/17

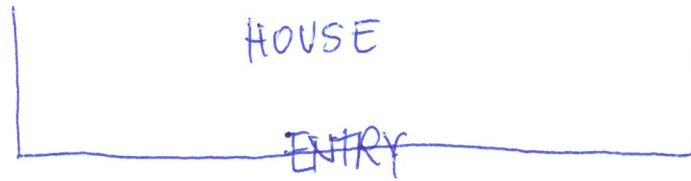

LEGEND

 = LAWN / TURF

 = existing tree

total area = 1,000 sqft.

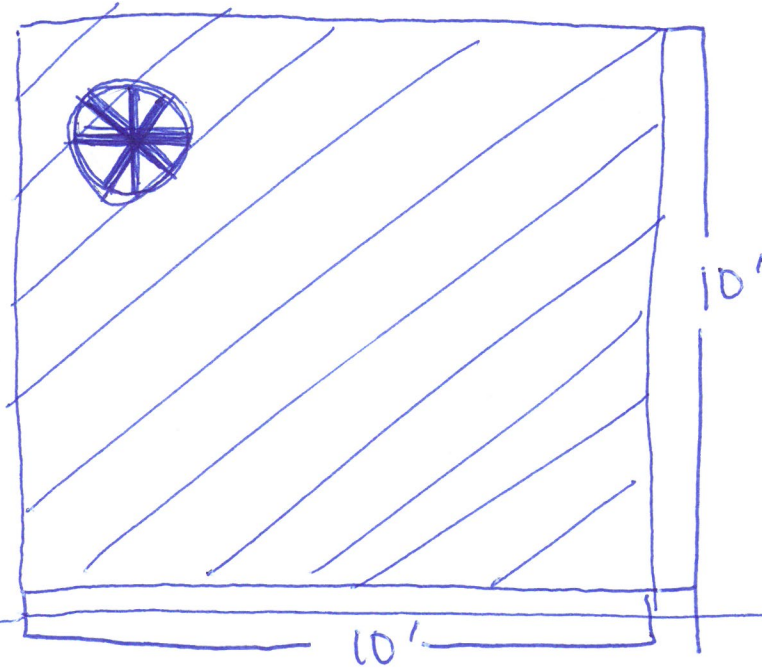

SIDEWALK

EXISTING FRONTYARD

2/1/17

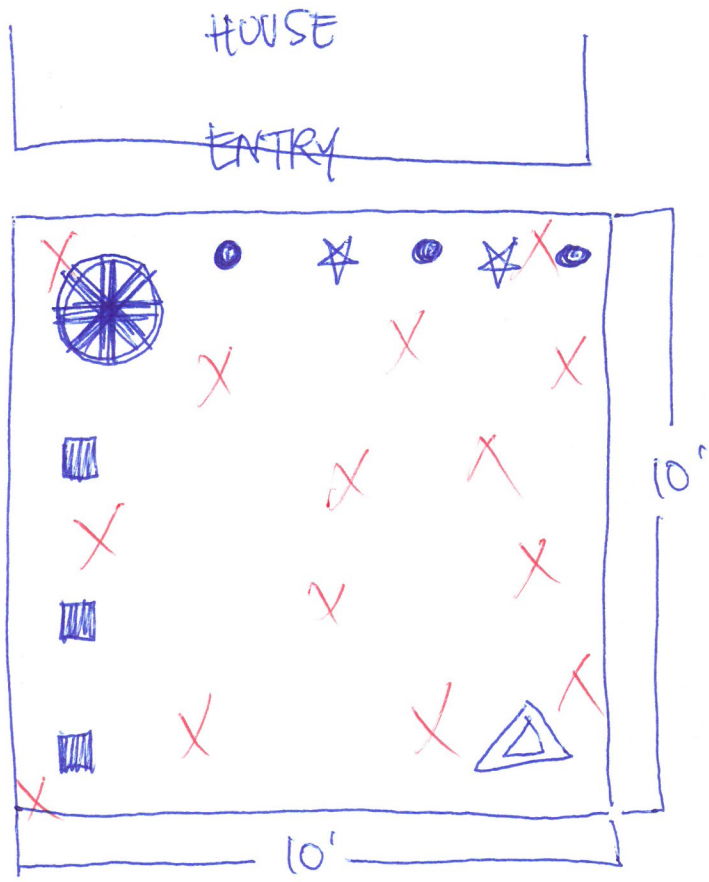

LEGEND:

X = mulch

☆ = sagebrush (2)
(groundcover)

● = sonoma sage (3)
(groundcover)

■ = woolly blue curls (3)
(shrubs)

△ = forest oak (1)
(trees)

total area = 10,000 sq ft

SIDEWALK

PROPOSED FRONTYARD