

0571

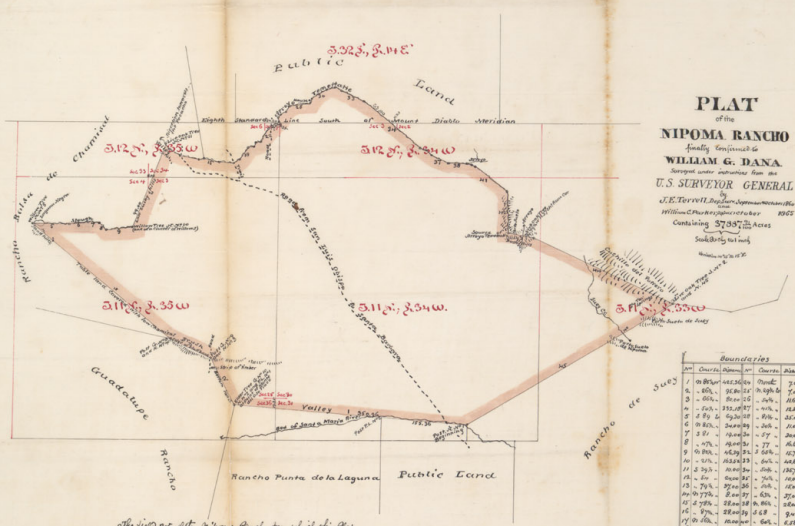

PLAT
of the
NIPOMA RANCHO
Saidly Contained in
WILLIAM G. DANA
Survey under authority from the
U.S. SURVEYOR GENERAL
by
J. E. Torvell Deputy Surveyor General
William Charles & Joseph Torvell 1867
Containing **5788 1/2** Acres
Subdivided into lots

Boundaries				
Lot	Course	Distance	Course	Distance
1	N 88° W	142.50	N 88° E	142.50
2	S 88° E	142.50	S 88° W	142.50
3	S 88° W	142.50	S 88° E	142.50
4	N 88° W	142.50	N 88° E	142.50
5	S 88° E	142.50	S 88° W	142.50
6	N 88° W	142.50	N 88° E	142.50
7	S 88° E	142.50	S 88° W	142.50
8	N 88° W	142.50	N 88° E	142.50
9	S 88° E	142.50	S 88° W	142.50
10	N 88° W	142.50	N 88° E	142.50
11	S 88° E	142.50	S 88° W	142.50
12	N 88° W	142.50	N 88° E	142.50
13	S 88° E	142.50	S 88° W	142.50
14	N 88° W	142.50	N 88° E	142.50
15	S 88° E	142.50	S 88° W	142.50
16	N 88° W	142.50	N 88° E	142.50
17	S 88° E	142.50	S 88° W	142.50
18	N 88° W	142.50	N 88° E	142.50
19	S 88° E	142.50	S 88° W	142.50
20	N 88° W	142.50	N 88° E	142.50
21	S 88° E	142.50	S 88° W	142.50
22	N 88° W	142.50	N 88° E	142.50
23	S 88° E	142.50	S 88° W	142.50
24	N 88° W	142.50	N 88° E	142.50
25	S 88° E	142.50	S 88° W	142.50

The said plat of the Nipoma Rancho from which this Plat has been drawn, having been examined and approved, same was signed in this Office
U. S. Surveyor General's Office
San Francisco California
May 24th 1867

L. Simpson
U. S. Surveyor Genl

Approved July 6. A. D. 1867
Celia Hoffman
Dist. Judge



13 SD
PAGE 108
No. 13 S.D.
William G. Dana, Claimant
Nipoma
Santa Barbara County
Attached to Final Report
Filed July 7 1865

UNIVERSITY MICROFILMS
SERIALS ACQUISITION
300 N ZEEB RD
ANN ARBOR MI 48106