

F.B.
O.K.
H.B.

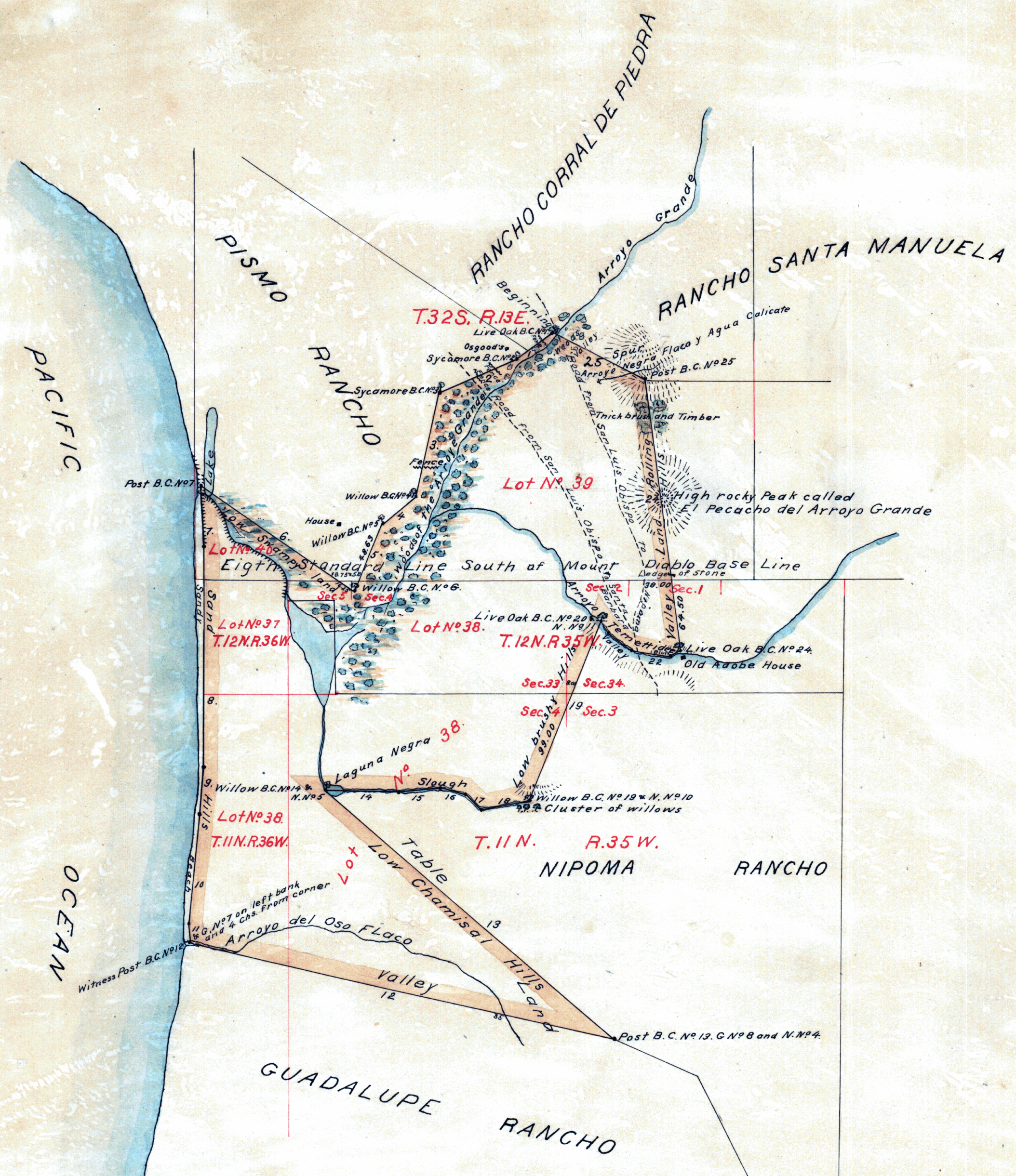

PLAT
of
RANCHO BOLSA DE CHEMISAL
finally confirmed to
L. T. BURTON
Surveyed under instructions from the
U.S. SURVEYOR GENERAL
by
J. E. Terrell Deputy Sur.
September 1860
Containing 14,335²²/₁₀₀ Acres
Scale 80 chs. to inch
Variation 14°30' East

Boundaries					
No	Course	Distance	No	Course	Distance
1.	S. 54 1/4° W.	36.72	14.	S. 89° E.	69.30
2.	- 67 1/2 "	75.45	15.	N. 85 1/2 "	34.00
3.	- 12 1/4 "	90.34	16.	S. 81 "	19.00
4.	- 50 "	39.00	17.	- 47 1/2 "	19.00
5.	- 21 3/4 "	57.80	18.	N. 82 1/2 "	45.39
6.	N. 57 1/4 "	161.74	19.	- 21 1/2 "	163.52
7.	S. 1 1/2 E.	52.60	20.	S. 29 1/4 "	10.00
8.	- 0 3/4 "	184.00	21.	- 54 "	24.00
9.	- 3 1/2 W.	40.00	22.	- 79 1/2 "	37.00
10.	- 6 "	93.00	23.	N. 77 3/4 "	8.00
11.	- 4 E.	18.74	24.	- 8 1/4 W.	235.66
12.	- 77 3/4 "	382.40	25.	- 63 1/2 "	89.00
13.	N. 30 1/4 W.	332.18			

Note. Notice of the approval of this Plat and its retention in Office for four weeks subject to inspection was published from 14th February to 7th March 1861 in pursuance of the Act of Congress of June 14th 1860.

J. W. Mandeville
U.S. Surv. Gen. Cal.

The field notes of the Rancho 'Bolsa de Chemisal' and from which this Plat has been made out, have been examined and approved and on file in this Office.
U.S. Surveyor General's Office,
San Francisco California
January 29th 1861.

J. W. Mandeville
U.S. Surv. Gen. Cal.

A full, true and correct Copy of the original Plat on file in this Office.
U.S. Surveyor General's Office,
San Francisco California,
August 24th 1866.

L. Upson
U. Surv. Gen. Cal.



DEPARTMENT OF THE INTERIOR,
GENERAL LAND OFFICE,
Washington, D. C. Feb. 8 1909.
I hereby certify that this is a true copy of the plat of official survey of the lands to which it relates, on file in this office.

352
Recorder, General Land Office

0 425